



2019 JAY FEATHER



*Our first camping trip!*  
Black Rock State Park 1986

**2**  
**YEAR**  
LIMITED  
WARRANTY



JAY FEATHER HYBRID



X23E MAIN INTERIOR



X23E KITCHEN



X23E MAIN INTERIOR



X23E OPEN



X23E CLOSED



JAY FEATHER



27BH MAIN INTERIOR



24BHM MURPHY BED UP



27BH BUNK STORAGE



24BHM MURPHY BED DOWN



27BH BAJA PACKAGE



# JAY FEATHER HYBRID FLOORPLANS

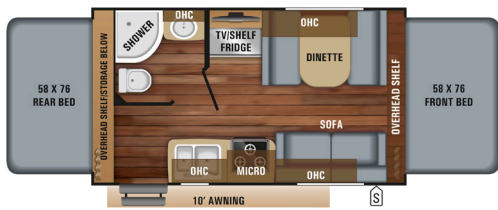

**X17Z**

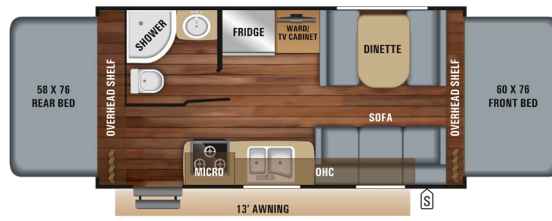

**X19H**

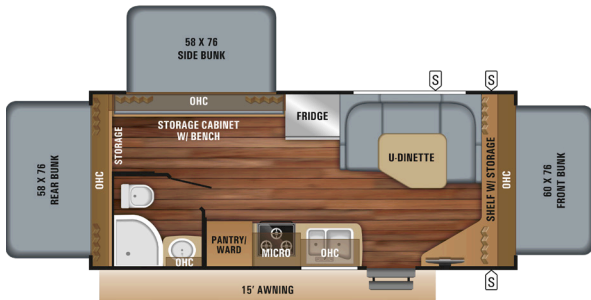

**X20D**

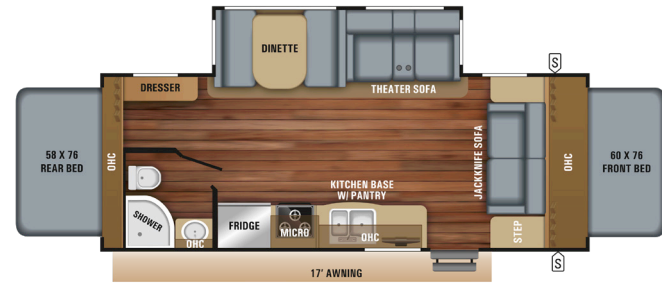

**X22N**

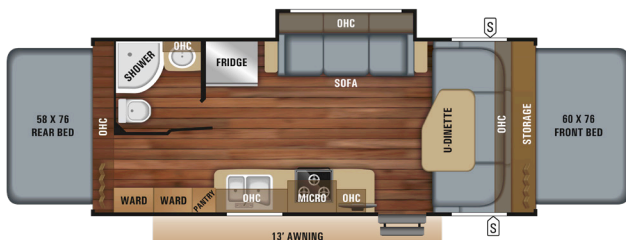

**X23B**

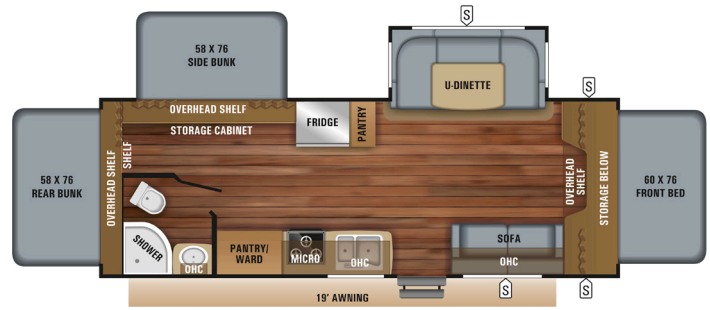

**X23E OPTION: B**

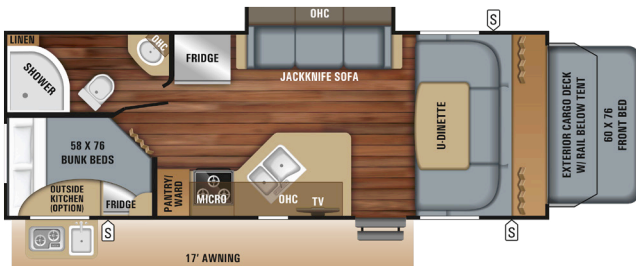

**X24K OPTION: A**

### LEGEND

- STORAGE
- TRAILER HITCH
- MICRO MICROWAVE
- OHC OVERHEAD CABINETS
- FRIDGE REFRIGERATOR
- WARD WARDROBE

### OPTIONS

- OPTION A**
  - KITCHEN STORAGE
  - FRIDGE
  - OUTSIDE KITCHEN OPTION
- OPTION B**
  - TRI-FOLD SOFA OPTION
- OPTION C**
  - THEATER SOFA OPTION

## JAY FEATHER HYBRID SPECS

FLOORPLAN	EXTERIOR TRAVEL LENGTH	EXTERIOR WIDTH	EXTERIOR HEIGHT (WITH A/C)	INTERIOR HEIGHT	UNLOADED VEHICLE WEIGHT	DRY HITCH WEIGHT	GROSS VEHICLE WEIGHT RATING	CARGO CARRYING CAPACITY	FRESH WATER CAPACITY (INCLUDES WATER HEATER)	GREY WASTE WATER CAPACITY	BLACK WASTE WATER CAPACITY	SLEEP CAPACITY
<b>X17Z</b>	18' 4"	8' 0"	10' 0"	6' 6"	3,195	450	3,950	755	28.5	30.5	22.5	6 - 7
<b>X19H</b>	20' 8"	8' 0"	10' 3"	6' 6"	3,815	367	4,950	1,135	48.0	30.5	22.5	6 - 7
<b>X20D</b>	22' 9"	8' 0"	10' 6"	6' 6"	4,070	426	5,000	930	48.0	30.5	30.5	7 - 8
<b>X22N</b>	TBD	8' 0"	TBD	6' 6"	TBD	TBD	TBD	TBD	TBD	TBD	TBD	5 - 6
<b>X23B</b>	24' 5"	8' 0"	10' 3"	6' 6"	4,425	495	5,500	1,075	48.0	30.5	22.5	6 - 7
<b>X23E</b>	26' 8"	8' 0"	10' 8"	6' 6"	5,105	620	6,150	1,045	48.0	30.5	22.5	8 - 9
<b>X24K</b>	TBD	8' 0"	TBD	6' 6"	TBD	TBD	TBD	TBD	TBD	TBD	TBD	8 - 9

\*Estimated

**Unloaded Vehicle Weight (UVW):** Sometimes referred to as "Dry Weight," UVW means the typical weight of this trailer as built at the factory. The UVW, as used in product literature and other promotional materials, does not include cargo, fresh water, propane, options or dealer-installed accessories.

**Gross Vehicle Weight Rating (GVWR):** GVWR means the maximum permissible weight of the trailer, including the UVW plus personal items, all cargo, fluids, options and dealer-installed accessories. The GVWR is equal to or greater than the sum of the UVW and the CCC.

It is important for your safety and enjoyment that your tow vehicle be adequately sized and equipped to tow and handle the GVWR of the RV you select. Review weights and rating of your tow vehicle and consult a competent advisor for questions or advice. Whether you are new to RVing or a veteran, get a feel for the performance of your tow vehicle before heading out on the roadways. When you tow an RV, you must drive differently than when you drive a single vehicle. Practice hooking up, driving, backing up and braking in a safe environment or seek out professional instruction. Jayco affixes a weight label to each RV which lists weight information for that vehicle. See specifications chart on next page.

**Cargo Carrying Capacity (CCC):** CCC means the maximum weight of personal items, food, fresh water, propane, tools, other cargo and dealer-installed accessories that can be carried by the trailer. CCC is equal to or less than GVWR minus UVW. The addition of options will decrease the CCC.

**Hitch Weight (HW):** The hitch weight, as used in product literature and other promotional materials, does not include cargo, fresh water, propane gas, options or dealer-installed accessories. The addition of these types of items will either add to or subtract from the stated hitch weight.



# JAY FEATHER FLOORPLANS

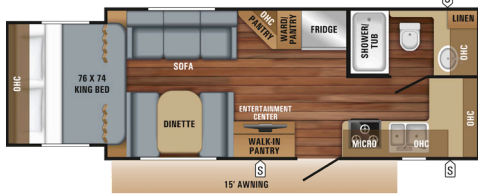

**X212**

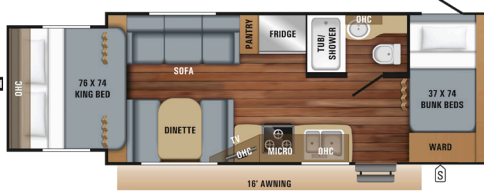

**X213**



**20BH OPTION: A**

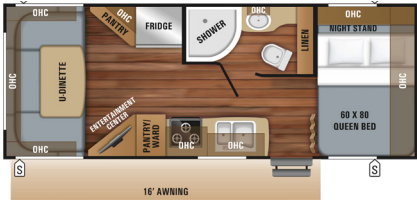

**21RD**

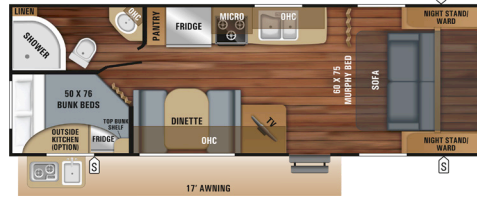

**23BHM OPTION: A**

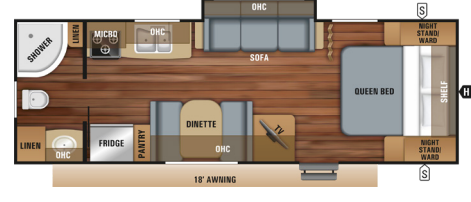

**23RB**

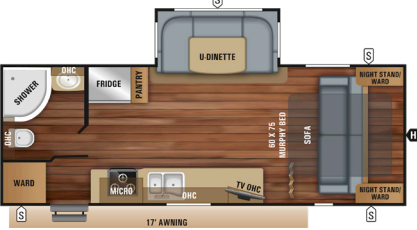

**23RBM OPTIONS: B, C**

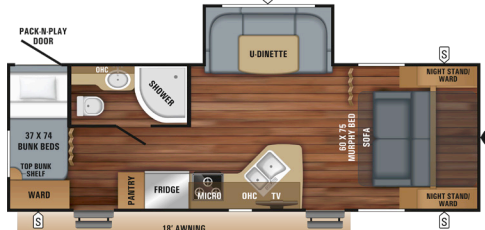

**24BHM**

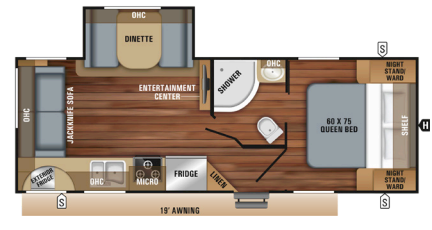

**24RL**

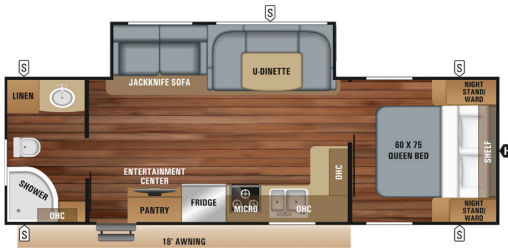

**25RB OPTIONS: A, B**

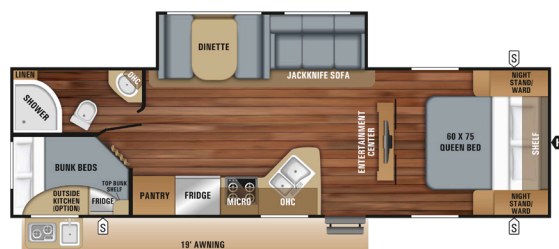

**27BH OPTIONS: A, B**

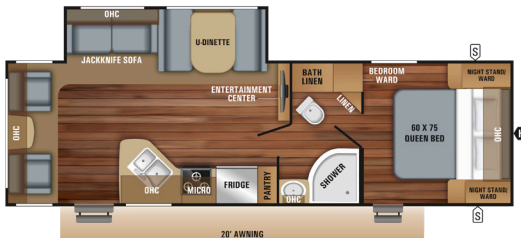

**27RL OPTION: B**

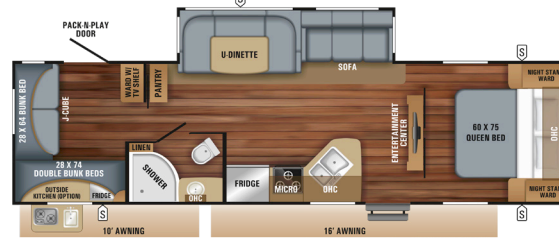

**29QB OPTIONS: A, B**

## JAY FEATHER SPECS

FLOORPLAN	EXTERIOR TRAVEL LENGTH	EXTERIOR WIDTH	EXTERIOR HEIGHT (WITH A/C)	INTERIOR HEIGHT	UNLOADED VEHICLE WEIGHT	DRY HITCH WEIGHT	GROSS VEHICLE WEIGHT RATING	CARGO CARRYING CAPACITY	FRESH WATER CAPACITY (INCLUDES WATER HEATER)	GREY WASTE WATER CAPACITY	BLACK WASTE WATER CAPACITY	SLEEP CAPACITY
<b>X212</b>	TBD	8' 0"	TBD	6' 6"	TBD	TBD	TBD	TBD	TBD	TBD	TBD	4 - 5
<b>X213</b>	24' 1"	8' 0"	10' 3"	6' 6"	4,460	438	5,500	1,040	48	30.5	22.5	6 - 9
<b>20BH</b>	TBD	8' 0"	TBD	6' 6"	TBD	TBD	TBD	TBD	TBD	TBD	TBD	5 - 8
<b>21RD</b>	TBD	8' 0"	TBD	6' 6"	TBD	TBD	TBD	TBD	TBD	TBD	TBD	3 - 4
<b>23BHM</b>	28' 9"	8' 0"	10' 3"	6' 6"	4,850	530	6,000	1,150	48	30.5	30.5	7 - 8
<b>23RB</b>	28' 3"	8' 0"	10' 3"	6' 6"	4,805	500	6,000	1,195	48	30.5	22.5	4 - 5
<b>23RBM</b>	27' 0"	8' 0"	10' 8"	6' 6"	5,040	525	6,250	1,210	48	30.5	30.5	3 - 4
<b>24BHM</b>	29' 2"	8' 0"	10' 8"	6' 6"	5,465	585	6,750	1,285	48	30.5	30.5	5 - 8
<b>24RL</b>	28' 5"	8' 0"	10' 10"	6' 6"	5,285	584	6,500	1,215	48	30.5	30.5	4 - 5
<b>25RB</b>	TBD	8' 0"	TBD	6' 6"	TBD	TBD	TBD	TBD	TBD	TBD	TBD	4 - 6
<b>27BH</b>	32' 4"	8' 0"	10' 11"	6' 6"	6,015	630	7,500	1,485	48	61*	30.5	8 - 10
<b>27RL</b>	31' 6"	8' 0"	10' 11"	6' 6"	5,755	650	7,000	1,245	48	30.5	30.5	4 - 6
<b>29QB</b>	34' 11"	8' 0"	10' 11"	6' 6"	6,425	725	7,500	1,075	48	61*	30.5	7 - 12



## STANDARDS AND OPTIONS

### STANDARD EXTERIOR EQUIPMENT

Aerodynamic, rounded front profile with front diamond plate  
 Modern retro graphics package with two-colored sidewall  
 Stronghold VBL™ vacuum-bonded, laminated floor, side, rear and front walls including slideout room walls  
 Vacuum-bonded, laminated bed platforms with reverse-cambered support (1,100 lb. capacity) (all hybrids)  
 Keyed Alike™ lock system on tent latches (all hybrids)  
 Magnum Truss™ Roof System with one-piece seamless DiFlex II material  
 Norco® NextGen frame with integrated A-frame  
 Single axle (X17Z only)  
 Dual axles (N/A X17Z)  
 G20 tinted safety glass windows  
 Marine-grade exterior speakers (2)  
 American-made Dexter EZ Lube® axles  
 Galvanized steel, impact-resistant wheel wells  
 Slideouts with double seals, barrier sponges and U-channel drip spout (select models)  
 30 amp service  
 Outside grill propane quick-connect port  
 Water-repellent, scratch-resistant Jayco DuraTek™ vinyl tent material with zipper windows (all hybrids)  
 Permanently attached tent-to-bed base design (all hybrids)  
 Rear camera backup prep (select models)  
 Folding assist handle on main entry doors

### STANDARD INTERIOR EQUIPMENT

Screwed and glued cabinetry  
 Smoked glass decorative inserts (select overhead cabinets)  
 Ball-bearing drawer glides with 75 lb. capacity  
 Crown molding on ceiling  
 LED lighting throughout  
 6 cu. ft. refrigerator (5 cu. ft. X17Z)  
 Residential oven with 3 burner cooktop and upgraded grate exterior  
 Residential-style seamless kitchen countertops  
 Vinyl plank-style flooring  
 Microwave  
 Plywood dinette, bunk and bed bases  
 Murphy bed design allowing pass-through exterior storage access  
 4 inch high density dinette cushions with vinyl backing  
 Woodgrain accent paneling on select interior walls  
 Jayco exclusive Simmons® mattress with bedspread (select models)  
 Jayco exclusive teddy bear "soft-touch" residential-style mattress (select models)  
 110V outlet and corner shelf in fixed bunks  
 USB/110V recessed tower in kitchen or living area  
 Plastic foot flush toilet in all models  
 Bath skylight and roof vent  
 Solid shower enclosure (select models)  
 Tub/shower surround (select models)

### CUSTOMER VALUE PACKAGE (MANDATORY)

American-made nitro-filled Goodyear® radial tires with self-adjusting brakes  
 Aluminum rims  
 20 lb. propane bottles with auto regulator (2)  
 13,500 BTU A/C  
 Spare tire with cover  
 Detachable power cord  
 Power awning with LED lights  
 Black tank flush  
 Outside shower  
 Exterior TV bracket with 110V electric and cable outlets  
 Power tongue with manual stabilizer jacks (4)  
 6 gallon gas/electric DSI water heater  
 Solar prep (roof mounted)  
 AM/FM/CD/DVD/Bluetooth® stereo  
 Enclosed underbelly with glacier package

### OPTIONS

Drying rack/sink cover  
 24 inch LED TV (select models)  
 32 inch LED TV (select models)  
 15,000 BTU roof-mounted A/C  
 Exterior grill  
 Fan-Tastic Fan power roof vent (placement specific per model)  
 Outside cook kitchen (select models)  
 Roof ladder (select models)  
 2-bike carrier rack (A-frame mounted)  
 Baja Edition 15 inch off-road Goodyear mud tires, aluminum rims, flipped axle, enclosed underbelly with foil insulation (select models)  
 Tri-fold sofa (select models)  
 50 amp service (23RL, 25BH, 27RL, and 29RB)  
 2nd A/C  
 Power stabilizing jacks (select models)  
 30 lb. propane bottles with auto regulator (2) (select models)

## INTERIOR DÉCOR

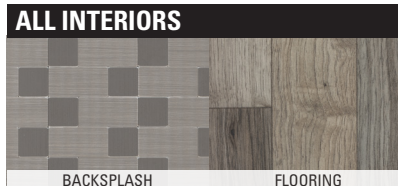
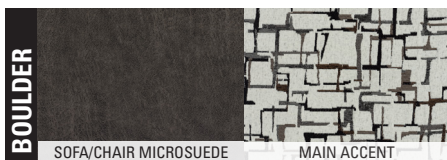



## EXPANDABLE TENTS DELIVER SPACE TO SPARE



### ENJOY AN EASY FOUR-STEP SETUP:

1. Unlatch the bed platform (left).
2. Guide the bed platform down.
3. Insert the bed bow brace (right).
4. Make the bed and enjoy!



### 5-YEAR TENT WARRANTY

We also offer five-year coverage on our tents, with parts, labor and freight covered the first two years; factory labor and return freight during years three, four and five.

## JAY FEATHER COMPETITIVE ADVANTAGES



American-made Dexter Axles with Self-Adjusting Brakes and Galvanized Wheel Wells

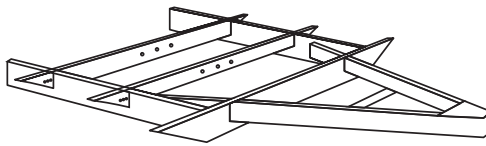

American-made Norco Frame with Integrated A-Frame



Enclosed Underbelly with Glacier Package



A-Frame and Roof Mounted Solar Prep



Rear Camera Back Up Prep



Rounded Front Profile with Increased Pass Through Storage



# Is your tow vehicle JAY FEATHER ready?



Scan to learn more

**2**  
YEAR  
LIMITED  
WARRANTY

**TRAVEL WITH  
CONFIDENCE**

At Jayco, we build our RVs to handle every adventure, then back them with our industry-leading 2-year limited warranty. We, with support from our select partners, have you covered for **2 camping seasons**. That's **730 days**. You won't find a better warranty in the business, because the only strings we attach are those that deliver the ultimate in reliability. That's the Jayco difference. So go explore. For a copy of our 2-year limited warranty with complete terms and conditions, please contact your local Jayco dealer.



JAYCO'S ROOF **vs.** OTHER ROOFS



4,500 POUNDS ON A JAYCO ROOF VS. OTHER ROOFS

**THE MAGNUM TRUSS™  
ROOF SYSTEM**  
**50 percent stronger**

**GOODYEAR**

Featuring Durawall® Technology—ENGINEERED  
to help you tow with confidence



MADE IN USA



Jayco, Inc. | P.O. Box 460 | Middlebury, IN 46540 RVIA

See dealer for further information and prices. All information in this brochure and on [www.jayco.com](http://www.jayco.com) is the latest available at the time of publication approval. Jayco reserves the right to make changes and to discontinue models without notice or obligation. Photography may show optional equipment or props used for decoration purposes only. RVs built for sale in Canada may differ to conform to Canadian codes. JAYCO and the JAYCO BIRD IN FLIGHT are registered trademarks of Jayco, Inc. Printed in USA 75K 7/2018 ©2018 Jayco, Inc. 274875

Follow Jayco  
#Jayco50



Meet your Jayco Dealer \_\_\_\_\_

We work hard—so you can play hard. From finding the perfect Jayco for your family to providing flexible financing options and full-service support, we're here to help.